

POLY GLASS VESSELS

PROVEN PERFORMANCE IN RESIDENTIAL AND LIGHT COMMERCIAL APPLICATIONS



Pentair® Poly Glass Vessels have been the industry standard for quality and performance for over 30 years. Featuring a one piece, seamless high density polyethylene liner and an encapsulated, leak free engineered polymer inlet, Poly Glass Vessels are designed to provide you with years of worry free performance.

FEATURES/BENEFITS

For residential and light commercial water softener/filtration applications

Slim diameter with capacities from 2 to 85 gallons

Unmatched strength and chemical resistance

5-year warranty for 7 in. - 21 in. vessels

MATERIAL OF CONSTRUCTION

Inner shell of high density polyethylene

Threaded inlet in various sizes: 2.5 in. 4 in.

APPLICATIONS

Residential/light commercial softening

Residential/light commercial filtration

Portable exchange tanks

OPERATING PARAMETERS

Maximum operating pressure – 150 psi

Maximum operating temperature – 120° F

PENTAIR DESIGN PARAMETERS

Safety factor – 4:1

Minimum burst at 600 psi

Tested to 250,000 cycles without leakage

NSF/ANSI STD. 44 DESIGN PARAMETERS

Safety factor – 4:1

Minimum burst at 600 psi

Tested to 100,000 cycles without leakage

COLOR OPTIONS

GR – Gray

BL – Blue

NA – Natural

BK – Black



This pressure vessel has been tested and certified by WQA according to NSF/ANSI Std. 44 for materials safety and structural integrity requirements and Std. 372 for lead free compliance.

AQUAREP S.R.L.
Calle 99 (ex Cuenca) N° 644
B1672AUI - Villa Lynch
Buenos Aires - Argentina
Tel.: (+5411) 4754-2146
info@aquarep.com.ar

SPECIFICATIONS FOR PE LINER TANKS

Vessel Dia.	Tank Size		Opening		Height with Base (LA)mm	Diameter (D)mm	Capacity Gallons	Ship Weight KG	Base
	in.	mm.	Top	Bottom					
7 in.	7×17	180×430	2.5 in.	N/A	431	185	2.3	1.8	STANDARD
	7×35	180×905	2.5 in.	N/A	905	185	5.2	3.2	STANDARD
	7×44	180×1130	2.5 in.	N/A	1138	185	6.7	3.8	STANDARD
8 in.	8×17	205×445	2.5 in.	N/A	431	210	3.0	1.9	STANDARD
	8×35	205×905	2.5 in.	N/A	901	210	6.6	3.4	STANDARD
	8×44	205×1130	2.5 in.	N/A	1133	210	8.7	4.4	STANDARD
9 in.	9×35	230×905	2.5 in.	N/A	904	234	8.3	3.9	STANDARD
	9×42	230×1085	2.5 in.	N/A	1070	234	10.1	4.8	STANDARD
	9×48	230×1230	2.5 in.	N/A	1247	234	11.8	5.6	STANDARD
10 in.	10×35	255×905	2.5 in.	N/A	908	257	10.2	4.5	STANDARD
	10×44	255×1130	2.5 in.	N/A	1138	257	13.1	5.6	STANDARD
	10×54	255×1390	2.5 in.	N/A	1389	257	16.4	7.2	STANDARD
12 in.	12×48	300×1235	2.5 in.	N/A	1229	306	20.6	8.2	STANDARD
	12×52	300×1340	2.5 in.	N/A	1327	306	22.2	8.5	STANDARD
	12×65	300×1650	2.5 in.	N/A	1650	306	28.1	11.8	STANDARD
13 in.	13×54	330×1400	2.5 in.	N/A	1366	333	27.0	9.7	STANDARD
14 in.	14×65	355×1670	2.5 in.	N/A	1659	366	38.0	13.3	STANDARD
	14×65	355×1670	4 in.	N/A	1679	366	38.0	13.9	STANDARD
16 in.	16×65	400×1670	2.5 in.	N/A	1671	406	49.0	17.3	STANDARD
	16×65	400×1670	4 in.	N/A	1682	406	49.0	17.9	STANDARD
18 in.	18×65	450×1670	4 in.	N/A	1701	480	64.0	31.4	SMC
21 in.	21×62	535×1690	4 in.	N/A	1702	565	84.0	29.1	SMC
	21×62	535×1690	4 in.	4 in.	2029	565	84.0	37.3	TRIPOD

*Measurements are subject to change without notice and are for reference only.

*Please refer the individual drawing for dimension, volumes and weight etc.



Detail 2.5 in. opening

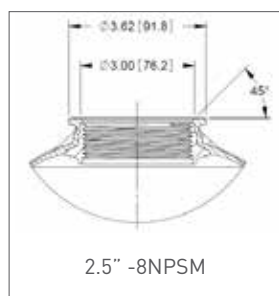

Detail 4 in. opening

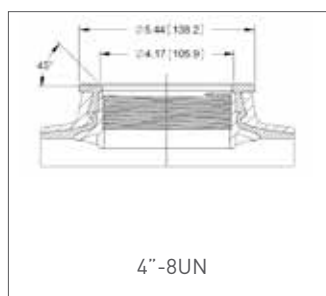

Detail base

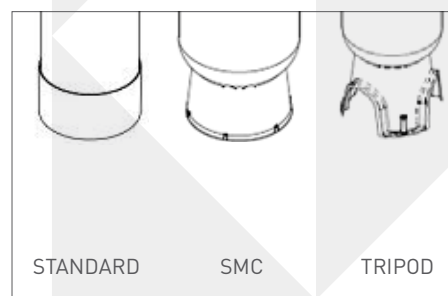

AQUAREP S.R.L.
Calle 99 (ex Cuenca) N° 644
B1672AUI - Villa Lynch
Buenos Aires - Argentina
Tel.: (+5411) 4754-2146
info@aquarep.com.ar



COMPOSITE VESSELS

PROVEN PERFORMANCE IN COMMERCIAL AND INDUSTRIAL APPLICATIONS



The non-corrosive, cost-effective solution for commercial/industrial water treatment and storage. Pentair® Composite Vessels offer fiberglass construction for outstanding performance and durability in harsh chemical environments. Available in capacities up to 900 gallons, composite vessels are available with a variety of different configurations.

FEATURES/BENEFITS

- 100% composite fiberglass construction
- Outstanding performance and durability
- Seamless design prevents from leakage
- Absolutely will not-and cannot-rust
- Factory-backed five-year warranty

MATERIAL OF CONSTRUCTION

- Polyethylene Inner shell
- Opening in various options:
 - 4 in. threaded,
 - 6 in. threaded,
 - 6 in. flanged.

APPLICATIONS

- Commercial/industrial softening
- Commercial/industrial filtration

OPERATING PARAMETERS

- Maximum operating temperature-
 - Thread inlet tank 49°C (120°F)
 - Flange inlet tank 65°C (150°F)
- Maximum vacuum: 127mmHg (5" Hg)

PENTAIR DESIGN PARAMETERS

- Safety factor – 4:1
- Minimum burst at 600 psi
- Tested to 250,000 cycles without leakage

NSF/ANSI DESIGN PARAMETERS

- Safety factor – 4:1
- Minimum burst at 600 psi
- Tested to 100,000 cycles without leakage

COLOR OPTIONS

GR – Gray	NA – Natural
BL – Blue	BK – Black



This pressure vessel has been tested and certified by WQA according to NSF/ANSI Std. 61 Section 8 and Std. 372 for lead free compliance.

SPECIFICATIONS FOR PE LINER TANKS

Vessel Dia.	Tank Size		Tank Opening		Tank Height		Diameter mm	Capacity Gallons	Ship Wt. KG	Base
	in.	mm.	Top	Bottom	(LA)mm	(LB) mm				
24 in.	24X72	610x1829	4"-8UN	\	1880	1743	613	119	63	SMC
	24x72	610x1829	4"-8UN	4"-8UN	2182	1764	625	119	63	TRIPOD
30 in.	30X72	762x1829	4"-8UN	\	2003	1775	764	187	106	SMC
	30X72	762x1829	4"-8UN	4"-8UN	2195	1772	764	187	99	TRIPOD
	30X72	762x1829	6"-8UN	\	1962	1737	764	187	106	SMC
	30X72	762x1829	6"-8UN	6"-8UN	2212	1796	767	187	99	TRIPOD
36 in.	36X72	914x1829	4"-8UN	\	2042	1776	914	264	132	SMC
	36X72	914x1829	4"-8UN	4"-8UN	2223	1791	914	264	132	TRIPOD
	36X72	914x1829	6"-8UN	\	2051	1784	914	264	132	SMC
	36X72	914x1829	6"-8UN	6"-8UN	2240	1818	917	264	132	TRIPOD
	36X72	914x1829	6" FLG	\	2090	1825	917	264	132	SMC
	36X72	914x1829	6" FLG	6" FLG	2275	1922	917	264	132	TRIPOD
42 in.	42X72	1067x1829	4"-8UN	4"-8UN	2330	1937	1073	345	204	TRIPOD
	42X72	1067x1829	6" FLG	6" FLG	2289	1854	1073	345	204	TRIPOD
48 in.	48X72	1981x1829	6" FLG	6" FLG	2335	1932	1226	463	249	TRIPOD
63 in.	63X67	1600x1702	6" FLG	6" FLG	2068	1704	1626	600	408	TRIPOD
	63X86	1600x2184	6" FLG	6" FLG	2513	2164	1626	900	454	TRIPOD

* Measurements are subject to change without notice and are for reference only.

**Please refer the individual drawing for dimension, volumes and weight etc.

NOTE: Flexible connections must be installed between hard piping and tank opening. Failure to install flex connection properly with the vessel will void the warranty.

NOTE: An adequate vacuum breaker must be installed if negative pressure exceed 127mmHg (5" Hg) inside.

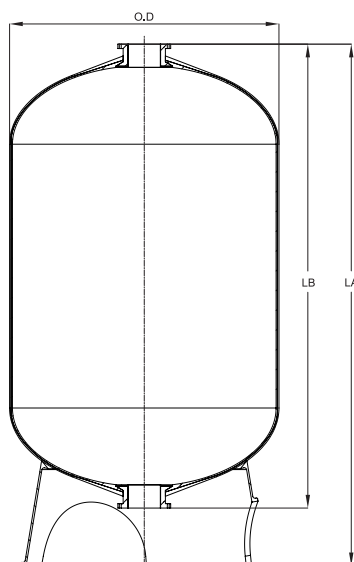

Detail opening

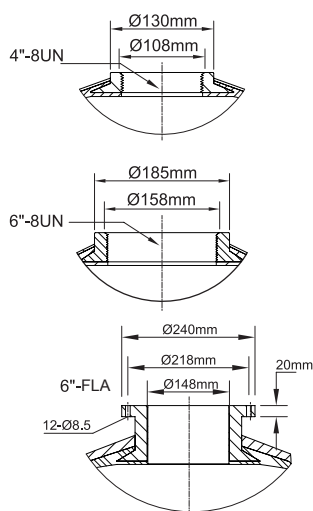

Detail base

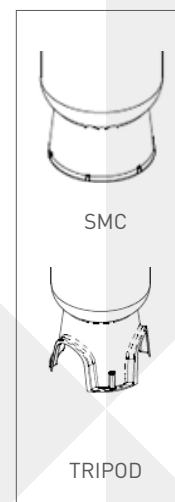

AQUAREP S.R.L.
Calle 99 (ex Cuenca) N° 644
B1672AUI - Villa Lynch
Buenos Aires - Argentina
Tel.: (+5411) 4754-2146
info@aquarep.com.ar